

# ENDO LINEAR CUTTER STAPLER WITH NON-STOP ARTICULATING LEVER

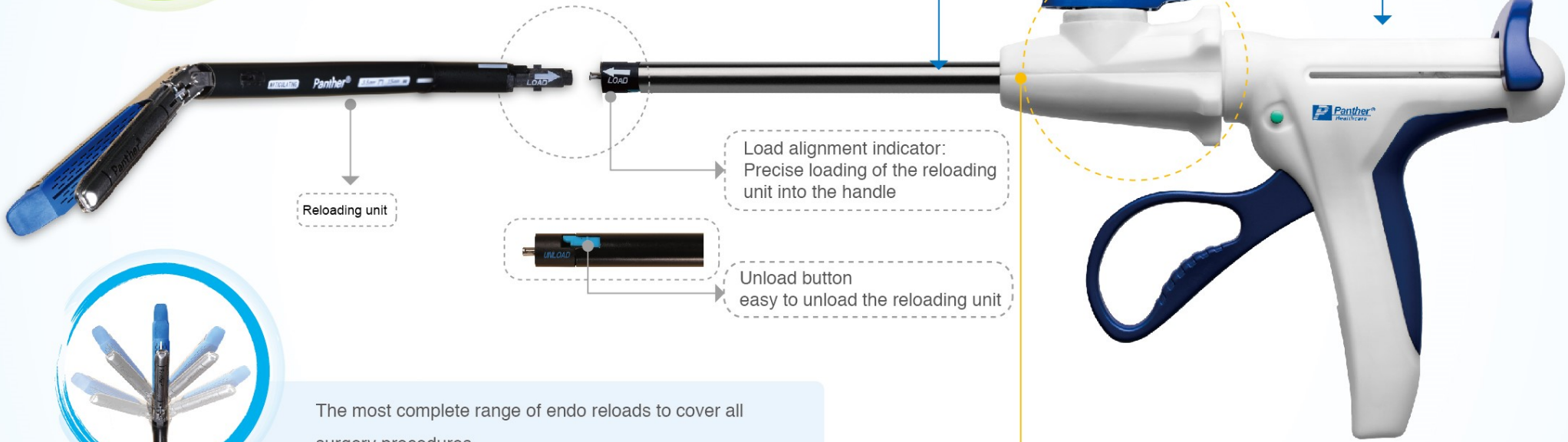

Wide jaw opening, allows easy placement on tissues  
Two triple, staggered rows of titanium staples, providing a secure staple line and a superior haemostasis



Universal handle for all reloading units, both straight and articulating, with three different lengths as 30mm, 45mm, or 60mm

Load alignment indicator:  
Precise loading of the reloading unit into the handle

Unload button  
easy to unload the reloading unit



The most complete range of endo reloads to cover all surgery procedures

Five different staple heights, 2.5mm, 3.5mm, 4.2mm, 4.8mm, 5.0 mm, addressed to various tissue thicknesses



Innovative 45 degrees Non-Stop articulation system

Universal handle with better design and ergonomics for easy 360 degrees knobbing