

**CRANIAL
FIXATION
DEVICE**

ntplast[®]
advanced biomedical solutions

NT CRANIAL[®]
Made in Italy by

ntplast[®]
advanced biomedical solutions

Ntplast srl
Via G. Donizetti, 20
00198 Roma - Italy

info@ntplast.com
+39 06 84083368



LITHO COMMERCIALE - 0143.744907

NT CRANIAL[®]
ntplast[®]
advanced biomedical solutions

NT CRANIAL[®]

PLASTIC DEVICE FOR THE STABLE
FIXATION OF THE CRANIAL FLAP

ONE PACKAGE TWO POSSIBLE CONFIGURATIONS

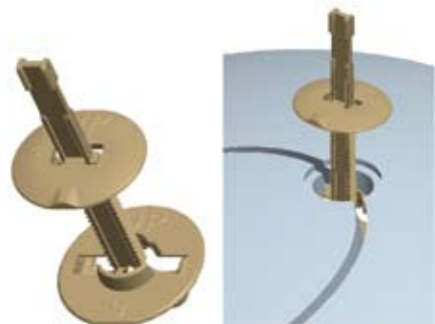

HOLE

to be placed in the holes made by the perforator.

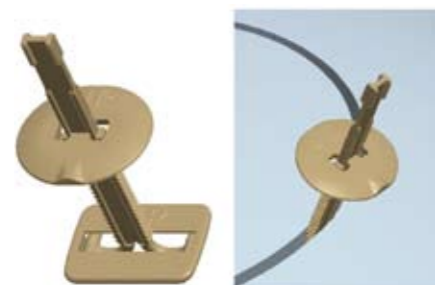

GAP

to be placed along the craniotomy cut.

The device is entirely made of biocompatible PEEK OPTIMA[®] polymer, which does not interfere with the execution of CT and MRI scan.

WARNING: The device is suitable for bone flaps with thickness between 2.5 mm and 20 mm.

CONFIGURATION SETUP

GAP

The device contained in the package is pre-assembled for the GAP configuration, to be completed by inserting the locking plate on the tensor.

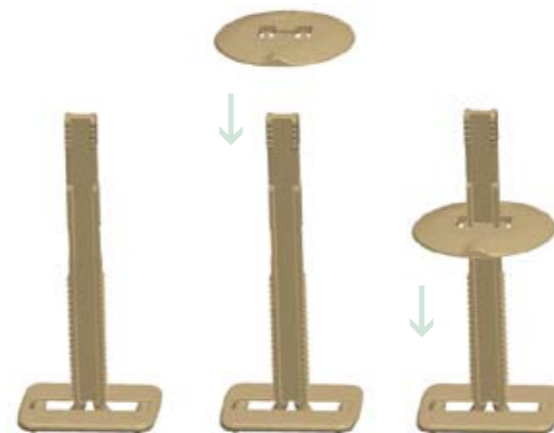

HOLE

To change to the HOLE configuration, the GAP base pre-assembled on the tensor needs to be removed and the HOLE base assembled in its place. This configuration is to be completed by inserting the locking plate.

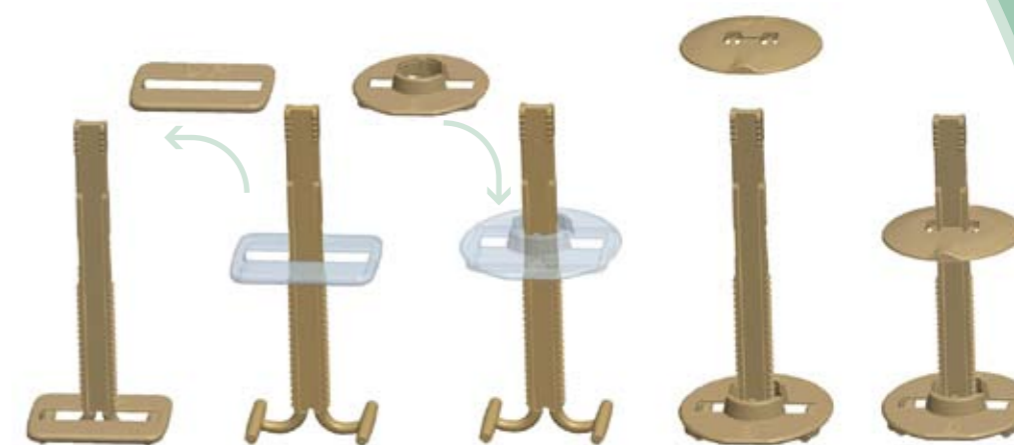

SURGICAL TECHNIQUE

Place the GAP configuration along the craniotomy cut and the HOLE configuration in the burr hole.



After inserting all the devices, place the cranial flap in the craniotomy site.

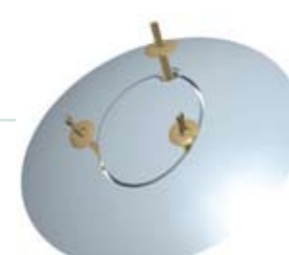

Push downward the plate in order to lock the device.

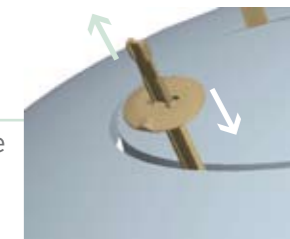

Remove the exceeding parts of the tensor using NT CRANIAL cutter.

